

# Welcome to Stockholm IPSCSG- MRI Workshop

October 28st, 2019

9.30-16.00

Register by sending an e-mail to [annika.roback@sll.se](mailto:annika.roback@sll.se)  
at the latest October 14, 2019



# IPSCSG program for MRI Workshop

## October 28st, 2019

### Stockholm, Sweden

Register by sending an e-mail to Annika Roback [annika.roback@sll.se](mailto:annika.roback@sll.se)  
at the latest October 14, 2019

Coffee and registration		09.30-09.55
Welcome	Annika Bergquist, Sweden	09.55-10.00
The value of contrast enhanced MRI in PSC including group discussions	Kristina Ringe, Germany	10.00-12.00
Lunch	Stockholm Food Blickagången	12.00-13.00
Short presentations – update on new results	<ul style="list-style-type: none"><li>• Multiparametric MRI/MRCP in PSC <i>Emmanuel Selvaraj, UK</i></li><li>• Is MRCP necessary for surveillance in PSC? <i>Aris Grigoriadis, Sweden</i></li><li>• Macroregenerative Nodules in PSC <i>Madrazo, Beatrice Luiza, US</i></li><li>• Detection of small duct PSC on MRI, <i>Kristina Ringe, Germany</i></li><li>• TBA?</li></ul>	13.00-14.00
Classification of strictures on MRI in PSC and Coffee	Aris Grigoriadis, Sweden Kristina Ringe, Germany	14.00-15.30
Summary, next meeting		15.30-16.00

#### Venue:

Karolinska University Hospital Huddinge, [Blickagången 16](#)

Meeting room: NEO DNA Lecture 5105, floor 5

Stockholm Sweden

*Karolinska University Hospital Huddinge is situated at 10 minutes' walk from the Flemingsberg train station, which is reached by train approx. 20 min from the Stockholm City commuter train station in Central Stockholm*

#### Contact/Organization

##### Meeting coordinators

Annika Bergquist, email [annika.bergquist@ki.se](mailto:annika.bergquist@ki.se)

Aristeidis Grigoriadis, email [aristeidis.grigoriadis@ki.se](mailto:aristeidis.grigoriadis@ki.se)

##### Administration

Annika Roback, email [annika.roback@sll.se](mailto:annika.roback@sll.se)

Very welcome to join us in Stockholm!



**Karolinska  
Institutet**

**KAROLINSKA**  
UNIVERSITY HOSPITAL

**To find the way from Stockholm Central Station to Karolinska University Hospital Huddinge.**

The train from Stockholm C to Karolinska University Hospital Huddinge takes about 20 minutes. You get off the train at Flemingsberg Station and from there you have a five min walk to the Hospital. There train from Stockholm Central station leaves every 15 min  
[At SL's website](#) you will find all travel information you need for buses, subways and trains.

Step off the train at Flemingsberg Station and walk to the exit through the train station. Take a right and follow the walkway and then take the escalator towards Huddinge hospital/collage (or University). Walk through the square and take a right at Södertörns library. Follow the signs to Flemingsbergs Center, Blickagången number 16. Enter the Entrance hall between the Espresso House and Stockholm Food and then take the door to the right. The meeting room DNA will be located at the Entrance.

Map [Blickagången 16](#)

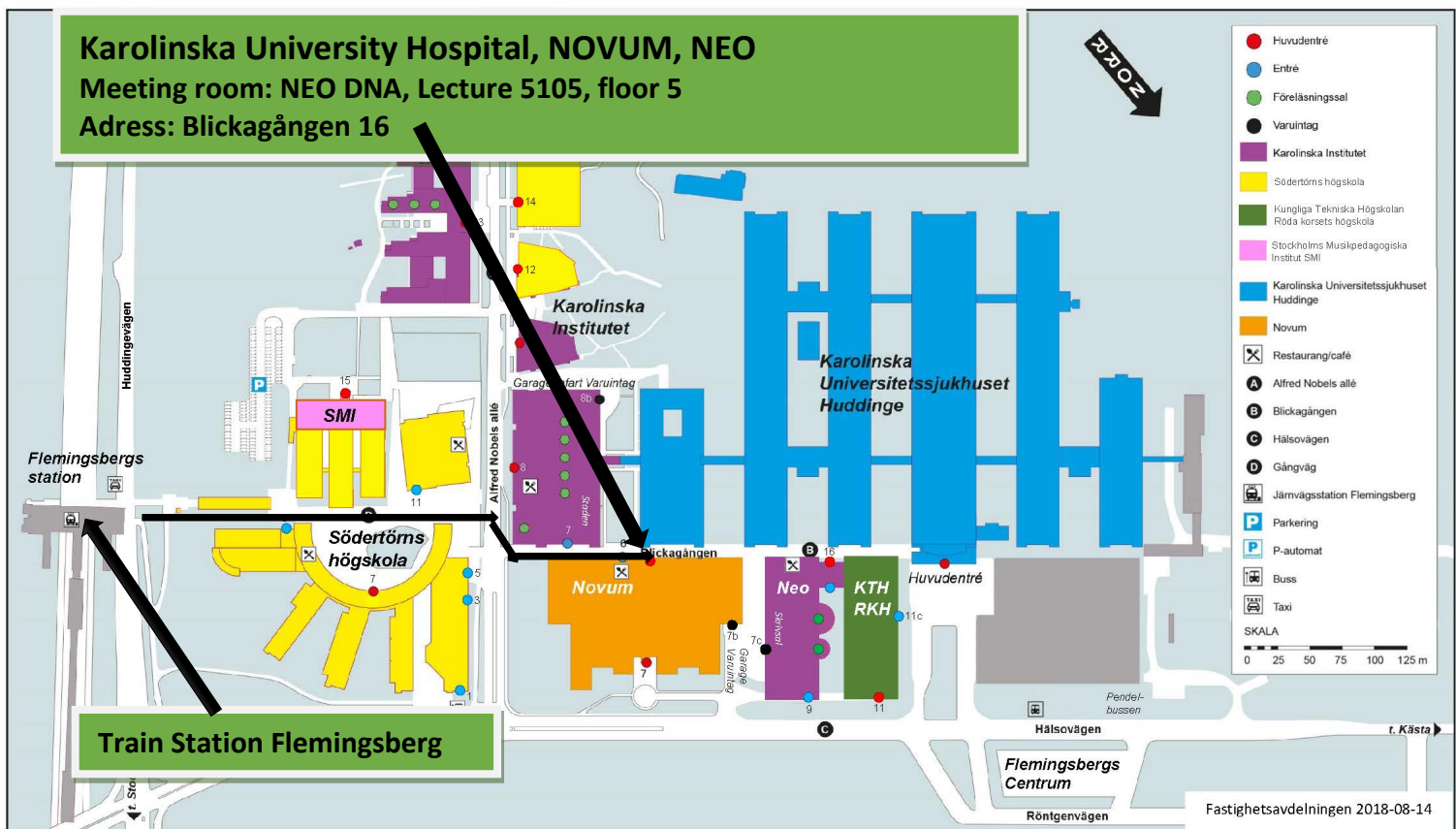

# Campus Flemingsberg



Hotel close Karolinska University Hospital, Flemingsberg

**Forenom Aparthotel Stockholm Flemingsberg**

Regulatorbron 8, 141 51 Stockholm

[www.forenom.com](http://www.forenom.com)

**Attendo Park Hotel**

Hälsövägen 22, 121 52 Huddinge

[www.attentoparkhotel.se](http://www.attentoparkhotel.se)

Hotel in Stockholm close to Arlanda Express and train station

**Comfort Hotel Stockholm**

Kungsbron 1,

111 22 Stockholm

E-post: [co.stockholm@choice.se](mailto:co.stockholm@choice.se)

[www.choice.se](http://www.choice.se)

**First Hotel Amaranten**

Kungsholmsgatan 31, Box 8054,

104 20 Stockholm

E-post: [amaranten@firsthotels.se](mailto:amaranten@firsthotels.se)

[www.firsthotels.com](http://www.firsthotels.com)

**Radisson BLU Royal Viking Hotel**

Vasagatan 1, Box 234,

101 24 Stockholm

E-post: [sales.royal.stockholm@radissonsas.com](mailto:sales.royal.stockholm@radissonsas.com)

[www.radissonblu.com](http://www.radissonblu.com)

**Best Western Hotel Terminus**

Vasagatan 20,

101 25 Stockholm

E-post: [info@terminus.se](mailto:info@terminus.se)

[www.terminus.se](http://www.terminus.se)

**Central Hotel**

Vasagatan 38,

111 20 Stockholm

E-post: [centralhotel@profilhotels.se](mailto:centralhotel@profilhotels.se)

[www.profilhotels.se](http://www.profilhotels.se)

**Clarion Hotel Sign**

Östra Järnvägsgatan 35

10126 Stockholm

Webbsida: [www.nordicchoicehotels.se](http://www.nordicchoicehotels.se)

**Elite Hotel Adlon**

Vasagatan 42

111 20 Stockholm

Webbsida: [www.elite.se](http://www.elite.se)